



Concept Pro

2MP

**4mm
Fixed
Lens**

**30M
IR**

4 in 1

CVP9316IREL-AHD2M/4 CVP9316IREL-AHD2M-G/4

Concept Pro Lite 2MP AHD Enhanced Low Light Fixed External Turret Camera (4mm)

The CVP9316IREL-AHD2M/4 model is a 4-in-1 analogue camera that has been designed to deliver the highest image quality for demanding external environments. This weather-resistant external turret features a 4mm fixed lens, smart infrared LEDs with 30m illumination range, and provides crisp 2-megapixel video at real-time frame rates with true wide dynamic range and enhanced low light performance. This camera is also designed for excellent compatibility with the Concept Pro range of hybrid digital video recorders.

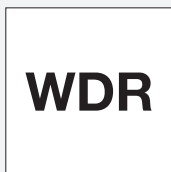

True Wide Dynamic Range

With true wide dynamic range, this camera can capture sharp images throughout the entire field of view, even when there are severe differences between light levels.

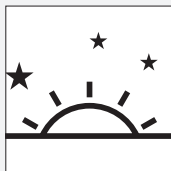

Enhanced Low Light Performance

This CCTV camera utilises an Enhanced Low Light CMOS sensor with greater light sensitivity, resulting in the camera capturing colour images long after standard CCTV cameras have switched to black and white night mode.

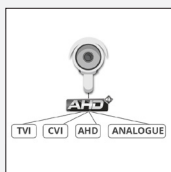

Four-in-one solution

Don't be tied down to any single analogue platform. With Concept Pro 4-in-1 cameras you have the freedom to install whichever CCTV platform you like, whether you install AHD, TVI, CVI, or traditional analogue systems.

KEY FEATURES

- ◆ Max. 25FPS @ 2MP
- ◆ 4mm Fixed Lens
- ◆ Up to 30m Smart IR Illumination
- ◆ 4-in-1 Operation (AHD/TVI/CVI/CVBS)
- ◆ Enhanced Low Light Performance
- ◆ True Wide Dynamic Range

OTHER FEATURES

- ◆ DC12V Power Input
- ◆ Up to Coax Coaxitron Support
- ◆ AGC, Sens-up, AWB, BLC, HLC, Defog
- ◆ IP66-rated

ANALOGUE HD TYPICAL CABLE DISTANCE

Camera

DVR

| | 5MP | 2MP | 720P |
|--------------------|------------|------------|------------|
| COAX (RG59) | UP TO 500M | UP TO 500M | UP TO 500M |
| CAT5e | UP TO 200M | UP TO 305M | UP TO 350M |
| CAT6 | UP TO 200M | UP TO 305M | UP TO 350M |

*Approximate distances calculated using HD MasterBaluns. Actual transmission range will vary depending on type and quality of cable and baluns.

COMPATIBLE WITH



CONCEPT PRO
AHD RECORDING
RANGE

CVP9316IREL-AHD2M/4 CVP9316IREL-AHD2M-G/4

Concept Pro Lite 2MP AHD Enhanced Low Light Fixed External Turret Camera (4mm)

Concept Pro

SPECIFICATION

| Model/Feature | CVP9316IREL-AHD2M/4 CVP9316IREL-AHD2M-G/4 |
|---------------------------------|--|
| Image Sensor | 1/2.8" Progressive Scan CMOS |
| Video Output Type | AHD/TVI/CVI/CVBS |
| Signal System | PAL/NTSC |
| Min. Illumination | Colour: 0.02 lux (Enhanced Low Light) B&W: 0.002 lux (Enhanced Low Light) 0 lux with IR on |
| Camera | |
| Electronic Shutter | Auto/Manual, 1/25-1/25,600s |
| S/N Ratio | ≥50dB |
| IR LEDs | x2 |
| IR Illumination Range | Max. 30m |
| IR Control | On/Off |
| Adaptable IR | Auto |
| Pivot Axis | Pan: 0-349°, Tilt: 0-80°, Rotation: 0-360° |
| Lens | |
| Lens Type | Fixed |
| Mount Type | Built-in |
| Focal Length | f=4mm |
| Aperture | F2.0 |
| Angle of View | H:82°, V:44°, D:99° |
| Focus | Fixed |
| Iris | Fixed |
| Resolution | 2MP (1920 x 1080), SD (960 x 576) |
| Frame Rate | AHD/TVI/CVI: 25/30FPS @ 2MP CVBS: 25/30FPS @ SD |
| Video | |
| Day/Night | True Day & Night with ICR (Auto/Colour/B&W/EXT) |
| Backlight Compensation | BLC/HLC |
| Wide Dynamic Range | True WDR |
| White Balance | Auto/AutoExt/Preset/Manual |
| Gain Control | Auto (AGC, 0-20) |
| Noise Reduction | 2D/3D-DNR (High/Middle/Low/Off) |
| Motion Detection | Yes |
| Defog | Yes |
| Image Setting | Freeze, Flip |
| Image Adjustment | Brightness, Sharpness, Colour Gain, Ace, Gamma |
| Privacy Masking | Yes |
| Sens-Up | Yes (x2/x4/x8/x16/x32/Off) |
| Transmission Distance | Max. 500m (1Vp-p 75Ω) |
| Interface | |
| Video Output | x1 1.0Vp-p 75Ω BNC (AHD/TVI/CVI/CVBS) |
| Audio Interface | - |
| RS-485 | - |
| Control Protocol | N/A |
| Up the Coax (Coaxitron) Support | Yes |
| OSD Buttons | Yes |
| General | |
| Power Supply | DC12V±10% |
| Power Output | - |
| Power Consumption | Max. 4.8W |
| Operating Temperature | -30°C to +40°C |
| Operating Humidity | 20-80% RH |
| Ingress Protection | IP66 |
| Impact Resistance | - |
| Housing Materials | Aluminum Diecasting |
| RAL | CVP9316IREL-AHD2M/4 - RAL 9010 Pure White CVP9316IREL-AHD2M-G/4 - RAL 7021 Black Grey |
| Dimension | Ø120 x (H) 94.8mm |
| Net Weight | ≈480g |
| Gross Weight | ≈630g |
| Certification | |
| Certifications | CE |

DIMENSIONS

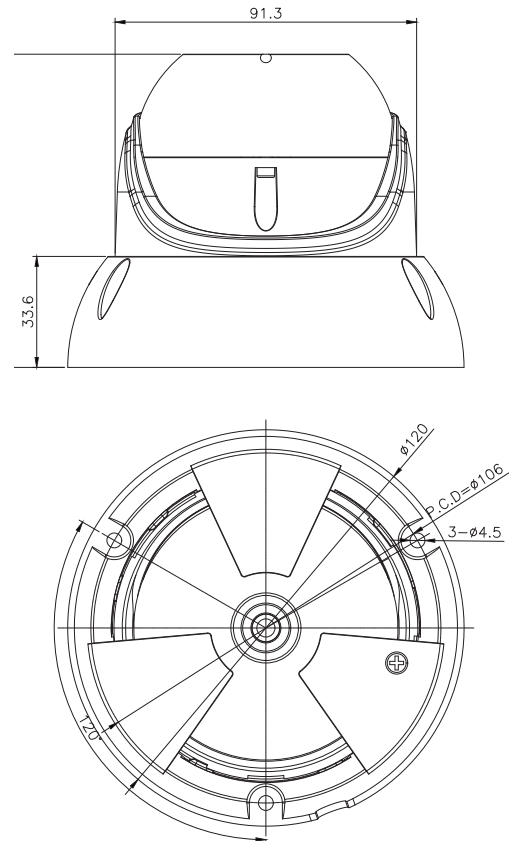

ORDER CODE

- **CVP9316IREL-AHD2M/4** Concept Pro Lite 2MP AHD Enhanced Low Light Fixed External Turret Camera (4mm)
- **CVP9316IREL-AHD2M-G/4** Concept Pro Lite 2MP AHD Enhanced Low Light Fixed External Turret Camera (4mm)

OTHER PRODUCTS IN THE RANGE

- **CVP9316IREL-AHD5M/2.8** Concept Pro Lite 5MP AHD Enhanced Low Light Fixed External Turret Camera
- **CVP9316IREL-AHD5M/2.8-G** Concept Pro Lite 5MP AHD Enhanced Low Light Fixed External Turret Camera (grey)
- **CVP9316IREL-AHD2M/2.8** Concept Pro Lite 2MP AHD Enhanced Low Light Fixed External Turret Camera
- **CVP9316IREL-AHD2M-G/2.8** Concept Pro Lite 2MP AHD Enhanced Low Light Fixed External Turret Camera (Grey)
- **CVP9316IREL-AHD5M/4** Concept Pro 5MP AHD Enhanced Low Light Fixed External Turret Camera (4mm)
- **CVP9316IREL-AHD5M/4-G** Concept Pro 5MP AHD Enhanced Low Light Fixed External Turret Camera (4mm) Grey

RECOMMENDED ACCESSORIES

- CP-BASE-1-V2 Concept Pro Small Junction Box
- CP-BASE-1-V2-G Concept Pro Small Junction Box Black Grey
- CP-WM-1-V2 Concept Pro Small Wall Mount
- CP-WM-1-V2-G Concept Pro Small Wall Mount Black Grey
- CP-PM-1-V2 Concept Pro Small Pendant Mount
- CP-PM-1-V2-G Concept Pro Small Pendant Mount Black Grey
- CP-PLM-V2 Concept Pro Pole Mount
- CP-CM-V2 Concept Pro Corner Mount
- RG59K-100 RG59 Coaxial Cable 100m (Black)
- RG59K-500 RG59 Coaxial Cable 500m (Black)

CVP9316IREL-AHD2M/G CVP9316IREL-AHD2M-G/4

Concept Pro Lite 2MP AHD Enhanced Low Light Fixed External Turret Camera (4mm)



ACCESSORIES

DIMENSIONS

CP-BASE-1-V2 CP-BASE-1-V2-G

Concept Pro Small Junction Box

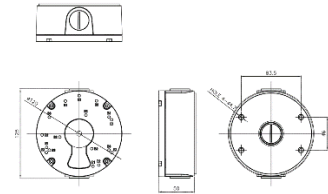

CP-PM-1-V2 CP-PM-1-V2-G

Concept Pro Small Pendant Mount

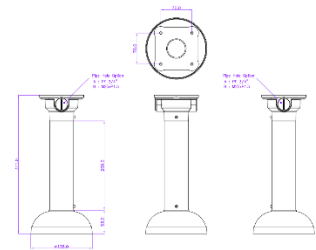

CP-WM-1-V2 CP-WM-1-V2-G

Concept Pro Small Wall Mount

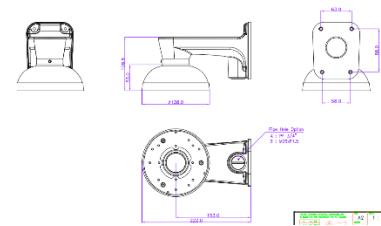
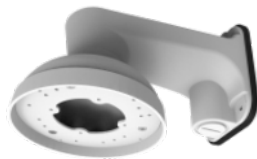

CP-PLM-V2

Concept Pro Pole Mount
(can be combined with CP-BASE-2-V2)

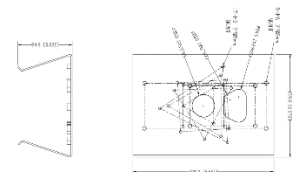

CP-CM-V2

Concept Pro Corner Mount
(can be combined with CP-BASE-2-V2)

